

ASSEMBLY AND INSTALLATION INSTRUCTIONS FOR

---

# BETTERLIFE™ SYSTEM 1



## PARTS LIST

- |                              |                                       |
|------------------------------|---------------------------------------|
| 1. Ultraviolet lamp          | 8. Fiberglass pressure tank           |
| 2. Acrylic sight glass       | 9. Control valve                      |
| 3. Red silicon o-ring        | 10. Riser adapter                     |
| 4. Quartz sleeve             | 11. Manifold head assembly            |
| 5. Stainless steel reflector | 12. Ballast box assembly with bracket |
| 6. Dome plug with o-ring     | 13. Riser extension                   |
| 7. Safety spring             | 14. Slotted strainer                  |

## ASSEMBLY AND START-UP PROCEDURE

1. Stand the BetterLife™ system in the installation site on a level surface.
2. Apply teflon tape to the threads on the riser adapter [10].
3. Thread the riser adapter into the threaded opening inside of the manifold head assembly [11].
4. On the bottom of the control valve [9], lubricate the small internal riser o-ring and the large tank adapter o-ring with a light coating of FDA approved silicone lubricant.
5. Thread the control valve [9] onto the manifold head assembly [11]. Tighten down by holding the base of the control valve until the face of the control valve is facing you. If you tighten while holding the face of the control valve, it will break off.
7. Place the red silicon o-ring [3] about 1 inch (25mm) from the open end of the quartz sleeve [4]. **Do not lubricate this o-ring!**
8. Carefully slide the closed end of the quartz sleeve [4] through the 1 inch threaded top opening in the manifold head assembly [11], down into the tank [8], until the red silicon o-ring [3] rests on the lip inside of the head. **Do not push the quartz sleeve all the way into the tank.** You may have to remove the back cover of the control valve to install the quartz sleeve.
9. Place the acrylic sight glass [2] over the open end of the quartz sleeve [4].
10. Screw the acrylic sight glass [2] firmly into the top of the manifold head assembly [11]. **Hand tighten only!** This will lock the quartz sleeve [4] into place. There will be a slight gap between the top of the head and the bottom of the sight glass.
11. Drop the safety spring [7] down into the quartz sleeve [4].
12. Install the control valve following the instructions in the Logix Control Valve manual.
13. While holding the ultraviolet lamp [1] by the white cap with the four pin connector, slide it carefully through the hole in the top of the sight glass [2] down into the quartz sleeve [4].

**NOTE:** Do not touch the glass part of the ultraviolet lamp with your fingers. Fingerprints will block the ultraviolet light and reduce dosage.

**Do not let go of the UV lamp!**

14. Plug the ultraviolet lamp [1] into the white connector on the ballast box assembly [12], then insert the lamp the rest of the way into the quartz sleeve [4].
15. Snap the plastic cap into the top hole of the acrylic sight glass [2]. This prevents direct UV light from escaping the system.
16. After the BetterLife system is completely installed, plug it into the wall outlet. It may take up to five (5) seconds for the lamp to turn on.

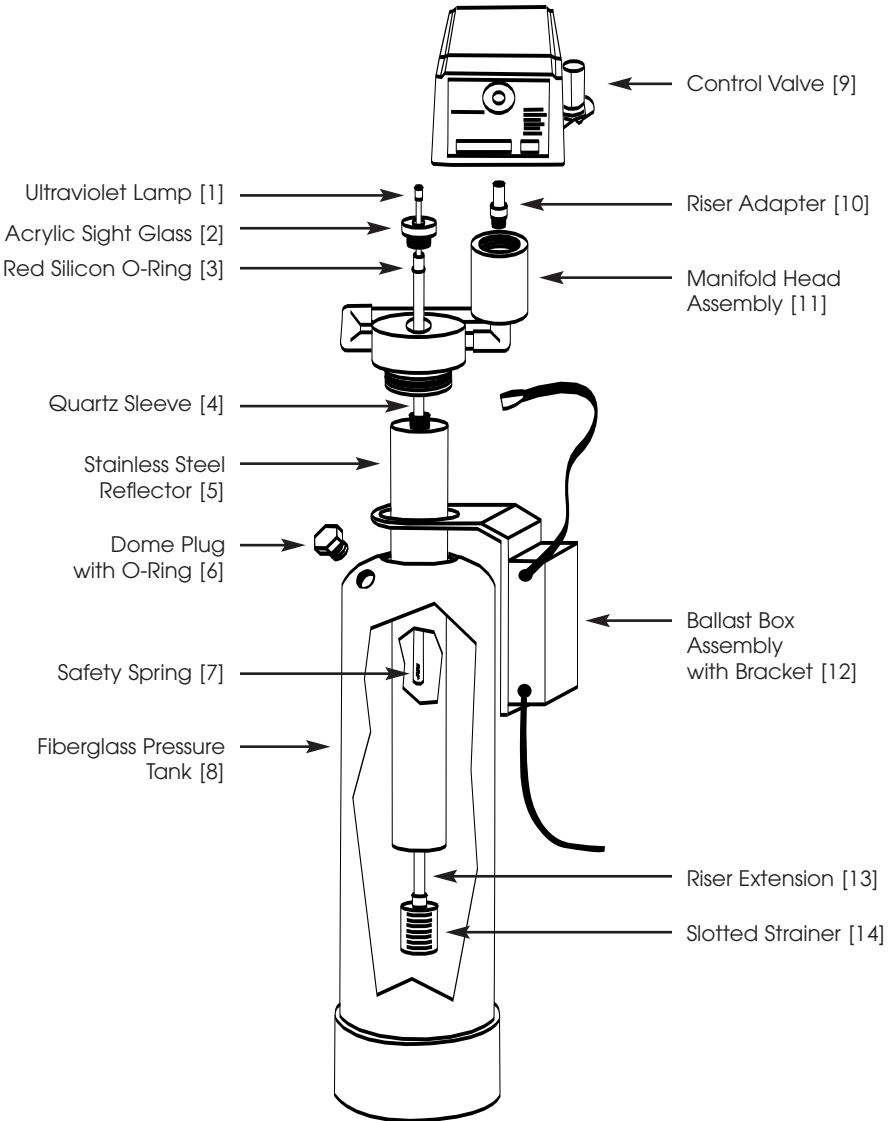

## BETTERLIFE SERIES SERVICE INFORMATION

### **Before servicing your BetterLife unit you must:**

- A) Unplug the unit from the wall.
- B) Relieve line water pressure from the unit by turning off the water supply to the unit, and then opening a tap or faucet down line from your BetterLife unit. Failure to do so may cause flooding or injury.

### **The BetterLife unit should have the following maintenance performed to keep the unit in peak operating efficiency.**

- A) Three months:

After the first three months in operation it is recommended that the quartz sleeve be inspected and wiped down with a damp cloth.

**If the quartz sleeve is clean;** you will not have to service your unit for another nine months. Then annually thereafter, unless some unforeseen, drastic change should occur in your water's chemistry.

**If the quartz sleeve is excessively dirty or has a rusty type coating;** this may be a sign that you need additional types of filtration for iron or other things in the water that the BetterLife unit was not designed to treat. You should repeat this cleaning procedure every 3 to 6 months to maintain a clear quartz sleeve for the UV light to transmit through. You may wish to contact your BetterLife representative for further inspection, testing, or information.

- B) Annually:

#### **The lamp must be changed every 12 months even if the lamp is still glowing!**

There is no exception to this rule. Even if the bulb is still lit, it may not be putting out an adequate dosage soon after this time frame. The BetterLife unit lamp emits a special UV wavelength light emission to sterilize bacteria and viruses. This special wave length is not visible to the naked eye. This special lamp is only capable of maintaining high dosage levels for slightly longer than one year. Adequate dosage levels should not be expected after that period of time, even if the lamp is still on. Contact your BetterLife representative for proper replacement lamps.

**For BetterLife System 1 owners;** It is recommended that the ProActive™ carbon bed be changed for a new bed every 2 to 3 years. This will keep your water at its best. The carbon in your unit is a high grade, bituminous coal based carbon for chemical, taste, color and odor removal, with a specific mesh sizing, that the manufacturer has deemed best for pre-ultraviolet filtration of sediment. Carbons of other nature are not recommended without professional guidance. Contact your BetterLife representative for further information about ProActive™ carbon bed replacements.

***Should you ever break a quartz sleeve inside the unit, do not turn the water back on under any circumstances. Unplug your unit and call a BetterLife service man or plumber immediately! Your unit will have to be completely cleaned of all glass, and will not operate properly without a replacement quartz sleeve.***

## **UV Quartz Sleeve Cleaning and Maintenance**

UV lamps produce heat and UVC output, which may cause certain water characteristics to adhere to and bond on the quartz sleeve. This can cause the quartz sleeve to foul. A fouled quartz sleeve will prevent the UVC from reaching the targeted pathogens.

Denatured alcohol, mild citric acid, or a lime/calcium/rust removal product (LimeAway or CLR) and a ScotchBrite pad (non-scratching) can be used to aid in the cleaning of the quartz sleeve. After the quartz sleeve is rinsed off with water and dry, wipe with a lint free cloth with denatured alcohol as a final step.

The quartz sleeve should be cleaned annually or more frequently, depending on the operating conditions.

Use gloves when handling a clean or new lamp and quartz sleeve. Skin oils will adhere to the lamp and quartz sleeve and prevent UV light from properly emanating.

A quartz sleeve should be changed every three (3) to five (5) years, or sooner if they show wear.